



Liquid receivers

→ RLHCY (horizontal) / RLVCY (vertical)

01/10

■ Applications

- Liquid receivers ensure the compensation of refrigerant volume variations in refrigerating and air conditioning installations.
- These volume variations are due to fluctuations generated by various operating temperatures at various seasons, and to the opening and closing sequences of the expansion valve, which fills - or not - the evaporator with its refrigerant.
- Liquid receivers also allow storage of the whole installation's refrigerant, for maintenance or trouble-shooting operations.

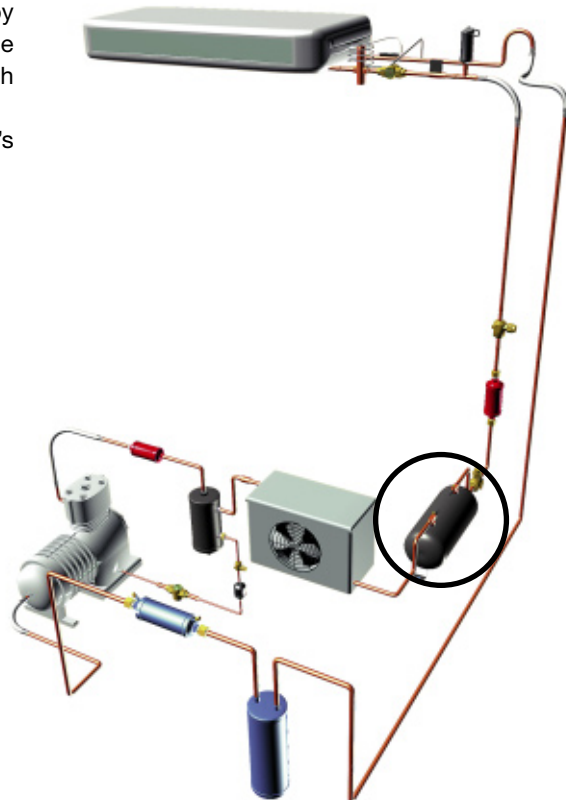

■ Functional features

- Products are compatible with HFCs, HCFCs, CFCs, as well as with their associated oils and additives. Products are designed for use of non-hazardous refrigerants from group 2 of PED 97/23/EC.
- Product classification in CE categories is performed using the PED 97/23/EC table, corresponding to a volume-based selection.
- Liquid receivers are entirely made of steel.
- They are fitted with fastening means suited to their volume and to their weight.
- From the 9-litre model and on, receivers come with a 3/8" NPT boss for mounting of safety elements such as safety valves.

■ CARLY advantages

- Liquid receivers are supplied perfectly clean and dried.
- They still offer both following connection possibilities:
 - Outside of the connections to screw.
 - Inside of the connections to solder.
- A wide range of accessories is available:
 - Rotalock stop valves, with connections to flare or to braze.
 - Rotalock connections with possibility of diameter reductions and with connections to screw or to solder.
 - Bracket sets for compressors.
- CARLY designs and manufactures special receivers, according to the specific needs of the user.
- GOST certified products .



Liquid receivers

→ RLHCY (horizontal) / RLVCY (vertical)

09/10

■ Recommendations

* Liquid receivers are to be mounted after the condenser.

* For optimal operation, special attention should be paid to the receivers' level: RLHCY receivers should be perfectly horizontal and RLVCY should be perfectly vertical.

* If sizing of the receivers is performed on the basis of the total refrigerant load, it is imperative to select receivers with an internal volume 20 % bigger, so that the gas reserve is always above the liquid level.

* General assembly precautions: refer to chapter 115.

Outside of the connections to screw

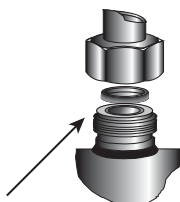

Inside of the connections to weld or to braze

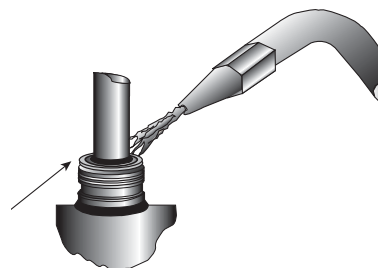

■ Technical features of RLHCY horizontal receivers

CARLY references	Outside of connections to screw UNF inch	Inside of connections to solder inch	Drawing Nb (1)	Dimensions (mm)									Net weight (kg)
				Ø1	L1	L2	E1	E2	E3	Ø2	L3	Ø3 NPTF (inch)	
RLHCY 15	3/4	1/4	1	89,0	332	282	210	61,0	/	M10	17,0	/	1,55
RLHCY 25	3/4	3/8	1	121,0	330	285	150	90,0	/	M10	17,0	/	2,95
RLHCY 30	3/4	3/8	1	121,0	366	321	186	90,0	/	M10	17,0	/	3,40
RLHCY 45	3/4	3/8	2	152,4	380	309	145	87,0	/	2 holes ø 10,5	17,0	/	5,55
RLHCY 60	1	1/2	2	152,4	463	391	228	81,5	/	2 holes ø 10,5	17,0	/	6,80
RLHCY 75	1	1/2	2	152,4	563	491	328	81,5	/	2 holes ø 10,5	17,0	/	8,15
RLHCY 90	1	1/2	3	152,4	258	599	436	81,5	192	4 holes ø 10,5	17,0	3/8	9,40
RLHCY 120	1 1/4	5/8	3	152,4	389	730	567	81,5	192	4 holes ø 10,5	22,5	3/8	11,80
RLHCY 150	1 1/4	3/4	3	168,3	352	753	582	85,5	200	4 holes ø 10,5	22,5	3/8	16,00
RLHCY 200	1 1/4	3/4	3	168,3	600	1001	830	85,5	200	4 holes ø 10,5	22,5	3/8	20,00
RLHCY 250	1 1/4	3/4	3	168,3	750	1249	1078	85,5	200	4 holes ø 10,5	22,5	3/8	23,00
RLHCY 300	1 1/4	3/4	3	219,1	402	907	691	108,0	220	4 holes ø 10,5	22,5	3/8	24,25
RLHCY 400	1 1/4	3/4	3	219,1	690	1196	979	108,0	220	4 holes ø 10,5	22,5	3/8	30,50
RLHCY 500	1 1/4	3/4	3	219,1	800	1485	1268	108,0	220	4 holes ø 10,5	22,5	3/8	36,50
RLHCY 600	1 1/4	3/4	3	323,9	455	856	559	148,0	320	4 holes ø 10,5	22,5	3/8	55,50
RLHCY 700	1 1/4	3/4	3	323,9	605	1005	709	148,0	320	4 holes ø 10,5	22,5	3/8	62,40

(1) Refer to drawings page 31.3



Liquid receivers

DTGB - 31.1-3-9-10

→ RLHCY (horizontal)

05/10

■ Technical features

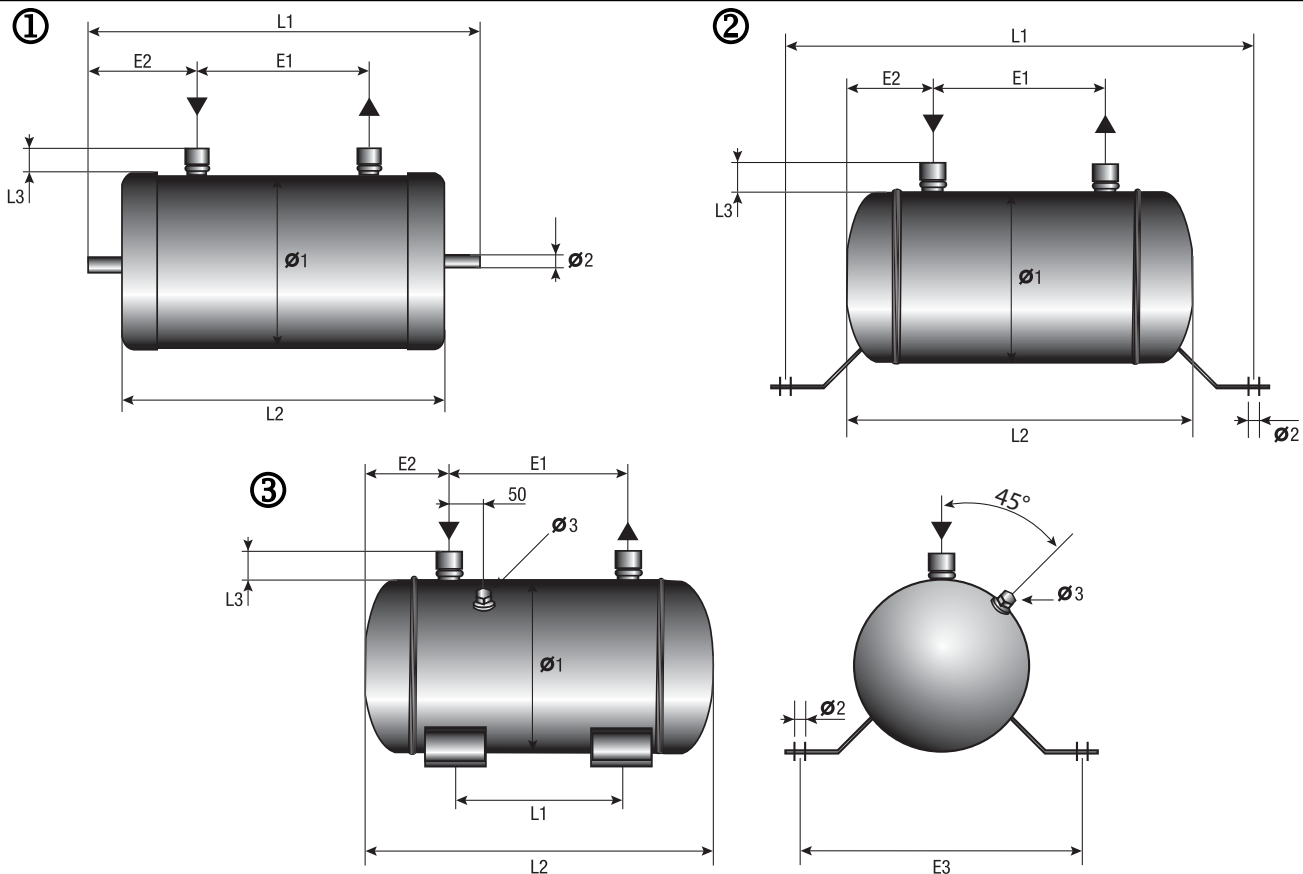

CARLY references	Volume	Maximal working pressure	Working pressure (1)	Maximal working temperature	Minimal working temperature	Working temperature (1)	CE Category (2)
	V (L)	PS (bar)	PS BT (bar)	TS maxi (°C)	TS mini (°C)	TS BT (°C)	
RLHCY 15	1,5	42,0	10	80	-40	-20	I
RLHCY 25	2,8	31,0	10	80	-40	-20	I
RLHCY 30	3,1	31,0	10	80	-40	-20	I
RLHCY 45	4,5	31,5	10	80	-40	-20	I
RLHCY 60	5,8	31,5	10	80	-40	-20	I
RLHCY 75	7,4	31,5	10	80	-40	-20	II
RLHCY 90	9,2	31,5	10	80	-40	-20	II
RLHCY 120	11,5	31,5	10	80	-40	-20	II
RLHCY 150	15,0	31,5	10	80	-40	-20	II
RLHCY 200	20,0	43,0	10	80	-40	-20	II
RLHCY 250	25,0	31,5	10	80	-40	-20	II
RLHCY 300	30,0	27,5	10	80	-40	-20	II
RLHCY 400	40,0	27,5	/	80	0	/	III
RLHCY 500	50,0	27,5	/	80	0	/	III
RLHCY 600	60,0	27,0	/	80	0	/	III
RLHCY 700	70,0	27,0	/	80	0	/	III

(1) The working pressure is limited to the PS BT value when working temperature is lower than or equal to TS BT value.

(2) Classification by volume, according to PED 97/23/EC (refer to chapter 0.7)



DTGB - 31.1-3-9-10

Liquid receivers

→ RLVCY (vertical)

01/10

■ Technical features

CARLY references	Outside of connections to screw UNF inch	Inside of connections to solder inch	Drawing Nb (1)	Dimensions (mm)									Net weight (kg)
				Ø1	L1	L2	E1	E2	Ø4	Ø2	L3	Ø3 NPTF (inch)	
RLVCY 09	3/4	1/4	1	89,0	209	184	110	37	/	M10	17,0	/	1,10
RLVCY 15	3/4	1/4	1	89,0	309	284	210	37	/	M10	17,0	/	1,75
RLVCY 20	3/4	1/4	1	101,6	288	266	140	63	/	M10	17,0	/	2,35
RLVCY 25	3/4	3/8	1	121,0	309	284	150	67	/	M10	17,0	/	2,95
RLVCY 30	3/4	3/8	1	121,0	345	320	186	67	/	M10	17,0	/	3,00
RLVCY 40	3/4	3/8	1	121,0	445	420	286	67	/	M10	17,0	/	4,10
RLVCY 45	3/4	3/8	2	152,4	333	311	145	84	/	M12	17,0	/	5,55
RLVCY 60	1	1/2	2	152,4	416	394	228	84	/	M12	17,0	/	6,80
RLVCY 75	1	1/2	2	152,4	516	494	328	84	/	M12	17,0	/	8,15
RLVCY 90	1	1/2	3	168,3	507	487	295	92	/	M12	17,0	3/8	10,00
RLVCY 120	1 1/4	5/8	3	168,3	622	603	410	92	/	M12	22,5	3/8	10,10
RLVCY 150	1 1/4	3/4	4	219,1	563	/	280	151	190	8 holes ø 10,2	22,5	3/8	16,65
RLVCY 200	1 1/4	3/4	4	219,1	713	/	430	151	190	8 holes ø 10,2	22,5	3/8	20,15
RLVCY 250	1 1/4	3/4	4	219,1	830	/	547	151	190	8 holes ø 10,2	22,5	3/8	24,00
RLVCY 300	1 1/4	3/4	4	323,9	534	/	160	205	290	8 slotted holes ø 10,2	22,5	3/8	34,00
RLVCY 400	1 1/4	3/4	4	323,9	670	/	296	205	290	8 slotted holes ø 10,2	22,5	3/8	41,30
RLVCY 500	1 1/4	3/4	4	323,9	802	/	428	205	290	8 slotted holes ø 10,2	22,5	3/8	49,40
RLVCY 600	1 1/4	3/4	4	323,9	934	/	560	205	290	8 slotted holes ø 10,2	22,5	3/8	56,00
RLVCY 700	1 1/4	3/4	4	323,9	1084	/	709	205	290	8 slotted holes ø 10,2	22,5	3/8	63,50

(1) Refer to drawings page 31.4 and 31.5

①

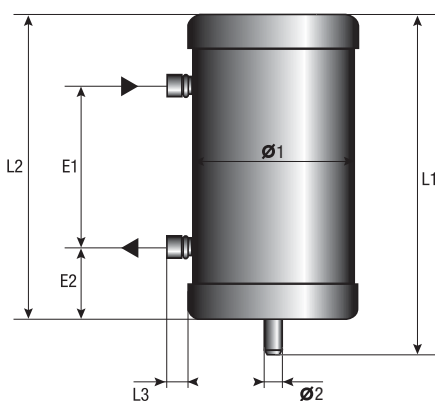

②

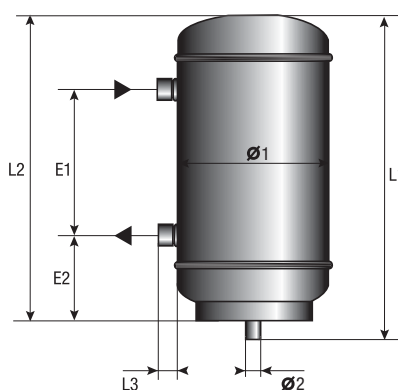

③

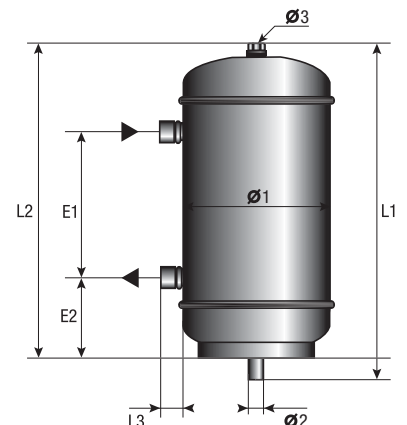



Liquid receivers

→ RLVCY (vertical)

05/10

■ Technical features

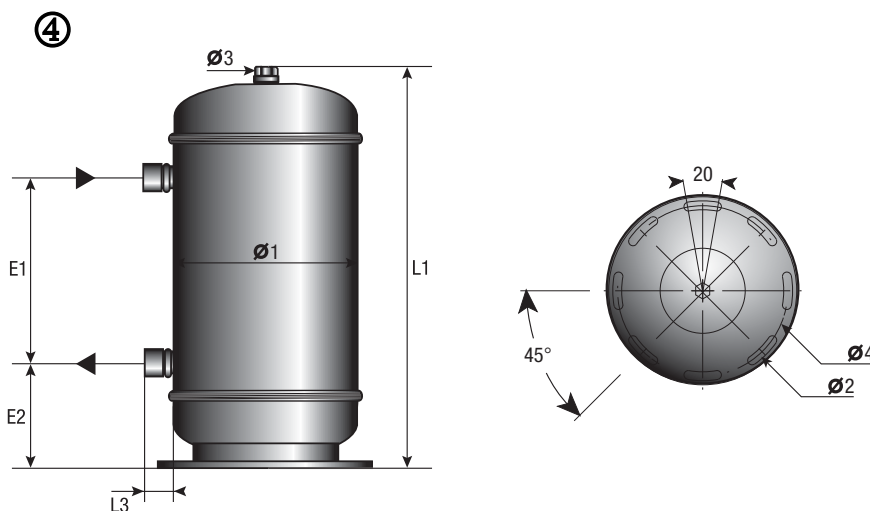

CARLY references	Volume	Maximal working pressure	Working pressure (1)	Maximal working temperature	Minimal working temperature	Working temperature (1)	CE Category (2)
	V (L)	PS (bar)	PS BT (bar)	TS maxi (°C)	TS mini (°C)	TS BT (°C)	
RLVCY 09	0,9	42,0	10	80	-40	-20	Art3§3
RLVCY 15	1,5	42,0	10	80	-40	-20	I
RLVCY 20	1,8	43,0	10	80	-40	-20	I
RLVCY 25	2,8	31,0	10	80	-40	-20	I
RLVCY 30	3,1	31,0	10	80	-40	-20	I
RLVCY 40	4,2	31,0	10	80	-40	-20	I
RLVCY 45	4,5	31,5	10	80	-40	-20	I
RLVCY 60	5,8	34,0	10	80	-40	-20	I
RLVCY 75	7,4	31,5	10	80	-40	-20	II
RLVCY 90	9,2	31,5	10	80	-40	-20	II
RLVCY 120	11,5	31,5	10	80	-40	-20	II
RLVCY 150	15,7	27,5	10	80	-40	-20	II
RLVCY 200	20,0	27,5	10	80	-40	-20	II
RLVCY 250	25,0	27,5	10	80	-40	-20	II
RLVCY 300	29,6	27,5	10	80	-40	-20	II
RLVCY 400	40,0	27,0	10	80	-40	-20	II
RLVCY 500	50,0	27,0	/	80	0	/	III
RLVCY 600	60,0	27,0	/	80	0	/	III
RLVCY 700	70,0	27,0	/	80	0	/	III

(1) The working pressure is limited to the PS BT value when working temperature is lower than or equal to TS BT value.

(2) Classification by volume, according to PED 97/23/EC (refer to chapter 0.7).



DTGB - 31.1-3-9-10

Liquid receivers

→ RLVCY (vertical)

01/10

■ Spare parts

CARLY references	Part N°	Description	RLHCY / RLVCY types	Quantity
CY 15580100	1	Gasket for 1/4" and 3/8" Rotalock connections and valves	09 to 45	1
CY 15580120	1	Gasket for 5/8", 7/8" and 1" 1/8 Rotalock connections and valves	120 to 700	1
CY 15580140	1	Gasket for 1/2" Rotalock connections and valves	60 to 90	1
CY 17400000	2	1/4" ODF Rotalock connection with gasket	09 to 45	1
CY 17400010	2	3/8" ODF Rotalock connection with gasket	09 to 45	1
CY 17400020	2	1/2" ODF Rotalock connection with gasket	60 to 90	1
CY 17400035	2	5/8" ODF Rotalock connection with gasket	120 to 700	1
CY 17400040	2	7/8" ODF Rotalock connection with gasket	120 to 700	1
CY 17400050	2	1" 1/8" ODF Rotalock connection with gasket	120 to 700	1
CY 17400100	2	1/4" SAE Rotalock connection with gasket	09 to 45	1
CY 17400110	2	3/8" SAE Rotalock connection with gasket	09 to 45	1
CY 17400120	2	1/2" SAE Rotalock connection with gasket	60 to 90	1
CY 19700080	3	1/4" ODF Rotalock valve with gasket	09 to 20	1
CY 19700110	3	3/8" ODF Rotalock valve with gasket	25 to 45	1
CY 19700120	3	1/2" ODF Rotalock valve with gasket	60 to 90	1
CY 19700135	3	5/8" ODF Rotalock valve with gasket	120 to 700	1
CY 19700160	3	7/8" ODF Rotalock valve with gasket	120 to 700	1
CY 19700170	3	1" 1/8" ODF Rotalock valve with gasket	120 to 700	1
CY 19700090	3	1/4" SAE Rotalock valve with gasket	09 to 45	1
CY 19700100	3	3/8" SAE Rotalock valve with gasket	09 to 45	1
CY 19700140	3	1/2" SAE Rotalock valve with gasket	60 to 90	1

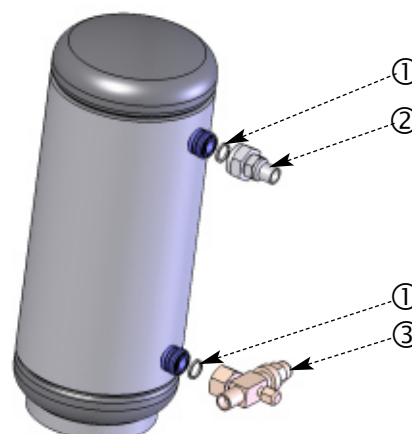
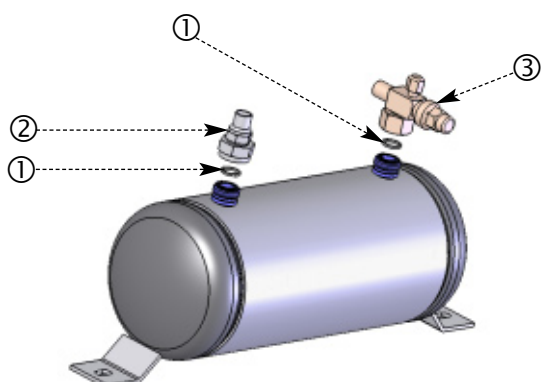



Liquid receivers

→ RLHCY (horizontal) / RLVCY (vertical)

01/10

■ Weights and packaging

CARLY references	Unit weight (kg)		Packaging unit	
	With packaging	Without packaging	standard	OEM'S
RLHCY 15	1,90	1,55	1	/
RLHCY 25	3,25	2,95	1	/
RLHCY 30	3,70	3,40	1	/
RLHCY 45	5,95	5,55	1	/
RLHCY 60	7,40	6,80	1	/
RLHCY 75	8,75	8,15	1	/
RLHCY 90	10,00	9,40	1	/
RLHCY 120	12,40	11,80	1	/
RLHCY 150	16,60	16,00	1	/
RLHCY 200	20,60	20,00	1	/
RLHCY 250	25,20	23,00	1	/
RLHCY 300	26,45	24,25	1	/
RLHCY 400	32,70	30,50	1	/
RLHCY 500	38,70	36,50	1	/
RLHCY 600	57,70	55,50	1	/
RLHCY 700	64,60	62,40	1	/

CARLY references	Unit weight (kg)		Packaging unit	
	With packaging	Without packaging	standard	OEM'S
RLVCY 09	1,50	1,10	1	/
RLVCY 15	2,15	1,75	1	15
RLVCY 20	2,75	2,35	1	/
RLVCY 25	3,20	2,95	1	8
RLVCY 30	3,35	3,00	1	/
RLVCY 40	4,20	4,10	1	6
RLVCY 45	5,85	5,55	1	/
RLVCY 60	7,10	6,80	1	/
RLVCY 75	8,50	8,15	1	/
RLVCY 90	10,35	10,00	1	/
RLVCY 120	10,60	10,10	1	/
RLVCY 150	17,15	16,65	1	/
RLVCY 200	20,80	20,15	1	/
RLVCY 250	24,60	24,00	1	/
RLVCY 300	34,80	34,00	1	/
RLVCY 400	42,10	41,30	1	/
RLVCY 500	50,60	49,40	1	/
RLVCY 600	57,20	56,00	1	/
RLVCY 700	64,70	63,50	1	/